



Fonderie Sime S.p.A. - Via Garbo, 27 - 37045 Legnago (VR) - [www.sime.it](http://www.sime.it)  
 Tribunale Verona 13531 - R.E.A. VR 171357 - C.C.P. 19423375 - N° Mecc. VR 014435  
 Capitale Sociale Euro 5.521.200 int. versato - Codice Fiscale/Partita IVA n. IT 01275930236

Comfort Ambiente - Via Garbo, 27 - 37045 Legnago (VR)

Tel +39 0442 631111 - Fax Servizio Commerciale: Italia +39 0442 631291 - Estero +39 0442 631293

Fax Servizio Tecnico +39 0442 631292 - Fax Ufficio Acquisti +39 0442 631292 - Fax Amministrazione +39 0442 631336

8092960 CALD.MUR.GAS. MET.FORMAT 30 BF

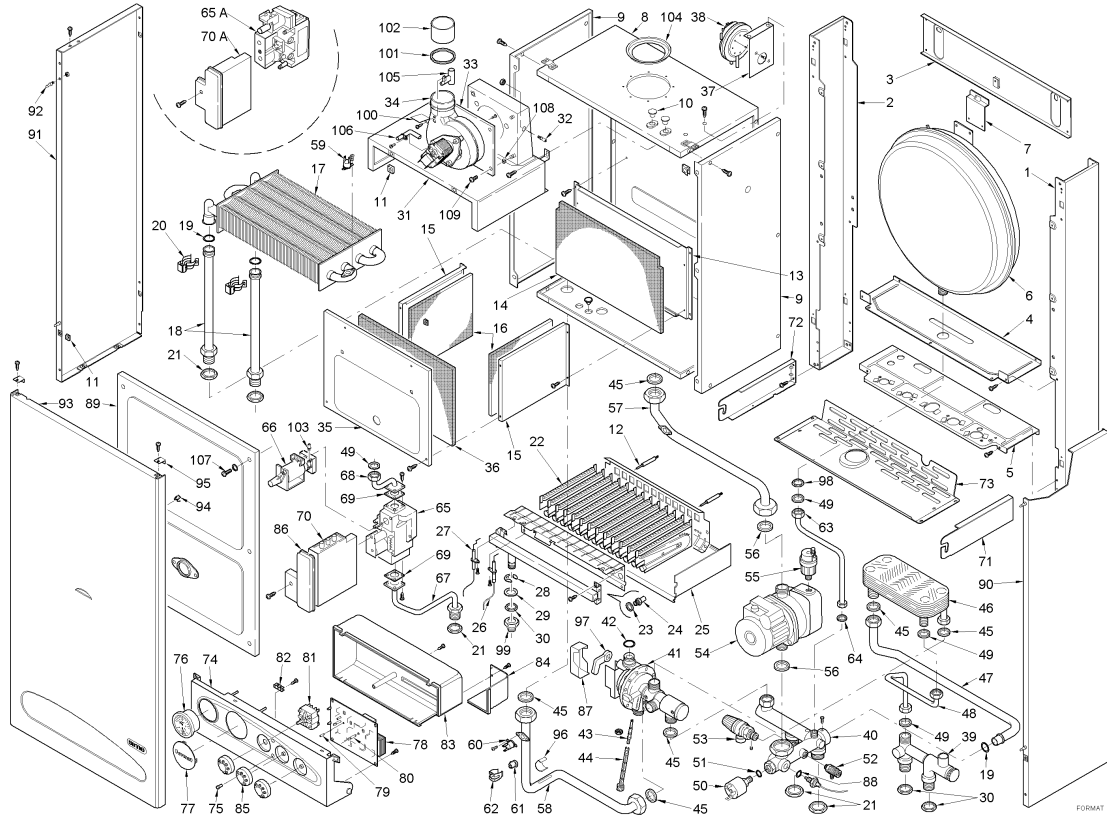

Position	Code	Description	Where used
001	6138521	Right hand side frame part	
002	6138621	Left hand side frame part	
003A	6138701	Frame assembly upper support	
004A	6255421	Expansion vessel lower support	
005A	6138857	Frame assembly lower side	
006A	5187700	Expansion vessel I.10 - 1/2" M	
007A	6140005	Expansion vessel fixing bracket	
008A	6266020	Sealed chamber rear panel	
009	6266110	Sealed chamber side panel	
010	6119313	Plastic cap	
011	2013302	Fastener for self tapping screw	
012	6223200	Burner centering pin	
013A	6266620	Combustion chamber rear panel	
014A	6139722	Combustion chamber rear insulat	
015	6139410	Combustion chamber side panel	
016	6139720	Combustion chamber side insulat	
017A	6174223	Heat exchanger PR24326004	
018	6265101	Heat exchanger inlet/outlet pip	
019	6226412	O-ring 3068	
020	6226601	Spring for heat exchanger conne	
021	6146302	Brass nut 3/4"	
022A	5172720	Main burner assembly	
023	6022004	Copper washer Ø 6	
024	6154402	Main burner nozzle NP 130 natur	
024B	6154411	Main burner nozzle NP 76 M6 LPG	
025A	6175104	Protecting shield	
026	6235920	Ignition electrode	
027	6235916	Ionisation electrode	
030	6146301	Brass nut 1/2"	
031A	5174511	Smoke chamber assembly	
033A	6229210	Fan mounting plate	
034A	6225613	Fan with venturi	
035A	6139608	Combustion chamber front panel	

036A	6139756	Combustion chamber front insula	
037	6229101	Smoke pressure switch bracket	
038A	6225708	Air pressure switch	
039	6265701	D.H.W. inlet/outlet manifold	
040	6265801	C.H. flow/return manifold	
041	6102805	Divertor valve	
042	6226417	O-ring 3043	
043	6218610	Filling cock spindle	
044	6272700	Filling cock extension	
045	2030228	Gasket Ø 17x24x2	
046A	6265600	Plate-type heat exchanger	
047	6264900	D.H.W. exchanger-C.H. manifold	
048	6265000	D.H.W. exchanger-D.H.W. manifold	
049	2030227	Gasket Ø 12x18x2	
050	6037502	Water pressure switch	
051	6226403	O-ring 2031	
052	6017210	Manual air vent 1/4"	
053	6040201	Pressure relief valve	
054A	6124806	Grundfos circulating pump UPS 1	
055	6013100	Automatic air vent 3/8"	
056	2030229	Gasket Ø 22x30x2	
057A	6264822	C.H. return pipe	
058A	6264721	C.H. flow pipe	
059	6146700	Limit stat auto reset	
060	6146701	100°C safety stat	
061	6231352	Temperature sensor	
062	6272500	Temperature sensor fixing sprin	
063	6227621	Pipe connecting expansion vesse	
064	2030226	Gasket Ø 10,2x14,8x2	
065	6243804	Honeywell gas valve type VK4105	
065A	6243802	SIT gas valve type Tandem 837	ALTERN.
066	6242404	Honeywell modureg type V7335A	
067	6226831	Gas inlet pipe	
068	6226932	Pipe connecting gas valve-main	
069	6162401	Square gasket	
070	6210201	Control box Honeywell S4565CF10	
070A	6210203	Control box SIT 503	ALTERN.
071A	6250011	Control panel R.H. side supp. b	
072A	6250111	Control panel L.H. side supp. b	
073	6219571	Lower closing panel	
074	6271900	Control panel	
075	6044022	Gem	
076	6217001	Temperature and pressure gauge	
077	6247313	Cap for time programmer	
078	6230679	Control board	
079	6201501	Trimmer spindle Ø 5	
080	6201502	Trimmer spindle Ø 6	
081	6260701	Rotary switch	
082	2211610	Earth faston	
083	6272000	Control panel protecting cover	
084	6272100	Room stat connection cover	
085	6230920	Knob Ø 40	
086	6174501	Honeywell control box cover	
087	6175400	Cover for micro switches	
088	6226411	O-ring 2015	
089A	6228880	Sealed chamber front panel	
090A	6274050	Casing right hand side panel	
091A	6273950	Casing left hand side panel	
092	2003000	Pin M5 Zn	
093	6271350	Casing front panel	
094	2015000	Spring clip	
095	6250300	Front panel fixing bracket	
096	2051100	Retaining spring	
097	6275900	Restrictor lever	
098	6146330	Nut 1/2" for expansion vessel	
099	6070807	Extension MF 1/2"	
100	6215109	Pressure switch sensor protect.	
101	6035906	Washer Ø 56,3x60	
102	6231402	Silicon rubber flue ring	
103	6235802	Pressure test point M5	
104	6028620	Air diaphragm Ø 81	
105	6223350	Venturi for fan	
106	6263902	Fan pressure test point	
107	2004180	Self-tapping screw TCB 8SPx3/4"	
108	2016020	Locked nut M4	
109	2000715	Screw TCB M4x10 AISI 304	
700	5187201	Complete control panel	

701	6127210	Main cable L=2000
702	6260956	2 pole female cable connector J
703	6260959	Honeywell control box cable con
704	6260964	6 pole female cable connector J
705	6260968	11 pole female cable connector
706	6259502	Smoke test point (coaxial flue
707	8092203	Time programmer kit
708	8089801	Frost Stat Kit
709	6146702	Frost stat
710	6223602	SIT gas valve coils (2 pieces)
711	6248202	Modulating coil red cartridge
712	6242402	SIT gas valve modulating coil 2
713	6245317	Temperature sensor connector
716	6260961	SIT control box cable connector
717	6233506	Fuse T1,6A 250V
719	5144708	Conversion kit to L.P.G.
720	5185403	Convers. kit to nat. gas 25-30-
721	6153101	Diaphragm assembly for diverter
722	6150700	Diverter valve microswitch